

LMB...UU 尼龍保持架  
該類型尺寸是英制的，主要是美洲採用。

LMB...UU (Resin retainer)  
This type is an inch dimension series  
mainly used in the America.

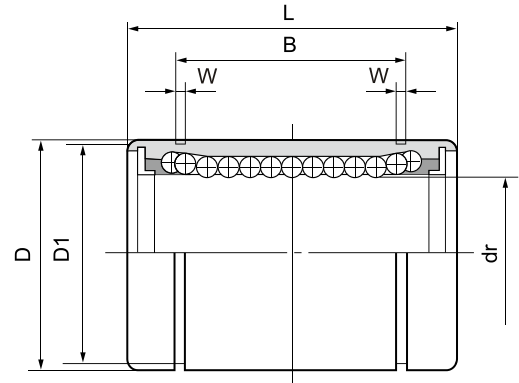

**LMB...UU**

**LMB...UU-AJ**

**LMB...UU-OP**

公稱軸徑 Nominal shaft diameter Inch/mm	尼龍保持架 Resin retainer									dr		
	標準型 LMB...UU	鋼球列數 Ball circuit	重量 Weight (gf)	間隙調整型 LMB...UU-AJ	鋼球列數 Ball circuit	重量 Weight (gf)	開口型 LMB...UU-OP	鋼球列數 Ball circuit	重量 Weight (gf)	Inch mm	公差 Tolerance Inch/ μm	
											精密 Precision	普通 High
1/4 6.350	LMB4	4	8.0	LMB4-AJ	4	7.5	—	—	—	.2500 6.350	0 -0.0025	0 -0.0040
3/8 9.525	LMB6UU	4	14	LMB6UU-AJ	4	13.5	—	—	—	.3750 9.525	0 -6	0 -9
1/2 12.700	LMB8UU	4	37	LMB8UU-AJ	4	36.5	LMB8UU-OP	3	28	.5000 12.700	0 -6	0 -9
5/8 15.875	LMB10UU	4	76	LMB10UU-AJ	4	74	LMB10UU-OP	3	57	.6250 15.875	0 -7	0 -10
3/4 19.050	LMB12UU	5	95	LMB12UU-AJ	5	93	LMB12UU-OP	4	76	.7500 19.050	0 -7	0 -10
1 25.400	LMB16UU	6	200	LMB16UU-AJ	6	198	LMB16UU-OP	5	170	1.0000 25.400	0 -7	0 -10
1-1/4 31.750	LMB20UU	6	440	LMB20UU-AJ	6	430	LMB20UU-OP	5	370	1.2500 31.750	0 -7	0 -10
1-1/2 38.100	LMB24UU	6	670	LMB24UU-AJ	6	660	LMB24UU-OP	5	570	1.5000 38.100	0 -8	0 -12
2 50.800	LMB32UU	6	1,140	LMB32UU-AJ	6	1,120	LMB32UU-OP	5	980	2.0000 50.800	0 -8	0 -12

密封型 Seal type:

LMB20UU

不標	不帶密封	No entry	No seals
U	單密封	U	Seal on one side
UU	雙密封	UU	Seal on both sides

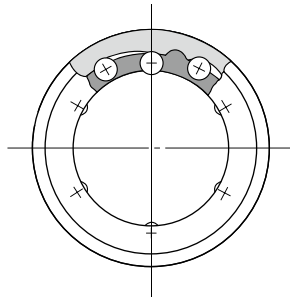

LMB...UU

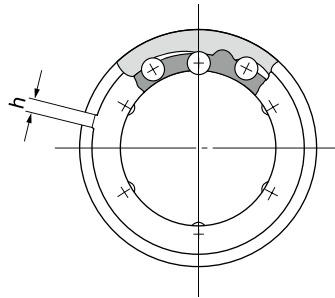

LMB...UU-AJ

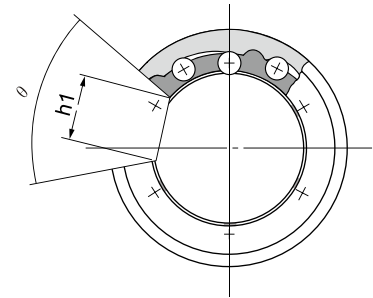

LMB...UU-OP

主要尺寸和公差 Major dimensions and tolerance											偏心 Eccentricity		最大徑向間隙 Radial clearance (Max)	額定負荷 Basic load rating	
Inch mm	公差 Tolerance Inch/μm	Inch mm	公差 Tolerance Inch/μm	Inch mm	公差 Tolerance Inch/μm	Inch mm	Inch mm	Inch mm	Inch mm	θ	精密 Precision	普通 High		Inch/μm	動負荷 Dynamic Co N
											.5000 12.700	$-\frac{0}{-11}$	.7500 19.050		
.6250 15.875	0	.8750 22.225	0 -.008	.6358 16.15	0 -.008	.0390 0.992	.5880 14.935	.04 1	—	—	.0003 8	.0005 12	-.0001 -3	225	314
.8750 22.225	-.00050 0	1.2500 31.750		.9625 24.46		.0459 1.168	.8209 20.853	.06 1.5	.34 7.9375	80°			-.0001 -4	510	784
1.1250 28.575	-13	1.5000 38.100	0 -200	1.1039 28.04	0 -200	.0559 1.422	1.0590 26.899	.06 1.5	.375 9.525	80°				774	1180
1.2500 31.750	0 -.00065	1.6250 41.275		1.1657 29.61		.0559 1.422	1.1760 29.870	.06 1.5	.4375 11.1125	60°	.0004 10	.0006 15	-.0002 -6	862	1370
1.5625 39.688	0 -16	2.2500 57.150	0 -.012	1.7547 44.57	0 -.012	.0679 1.727	1.4687 37.306	.06 1.5	.5625 14.2875	50°				980	1570
2.0000 50.800	0 -.00075	2.6250 66.675		2.0047 50.92		.0679 1.727	1.8859 47.904	.10 2.5	.625 15.875	50°	.0005 12	.0008 20	-.0003 -8	1,570	2,740
2.3750 60.325	0 -19	3.0000 76.200	0 -300	2.4118 61.26	0 -300	.0859 2.184	2.2389 56.870	.12 3	.75 19.05	50°				2,180	4,020
3.0000 76.200	$-\frac{0}{-22}$	4.0000 101.600		3.1917 81.07		.1029 2.616	2.8379 72.085	.12 3	1.0 25.40	50°	.0007 17	.0010 25	-.0005 -13	3,820	7,940

國際單位: 1N=0.225lbs  
1kg=2.205lbs  
SIUNIT: 1N=0.225lbs  
1kg=2.205lbs